



Riverside County

AGRICULTURE

The official publication of Riverside County Farm Bureau, Inc.

A private, nonprofit organization serving farmers throughout Riverside County since 1917

RCFB CELEBRATES ITS 91ST YEAR

The Riverside County Farm Bureau (RCFB) celebrated its 91st year at the RCFB Annual Meeting held at the Palm Desert Country Club in Palm Desert.



From L - R: State Senator-elect John Benoit, Rodger Siems, Ellen Sanders Way, and RCFB President Grant Chaffin

This year, the Howie Award was presented to two outstanding individuals, Ellen Sanders-Way of La Quinta and Rodger Siems of Hemet.

Ellen Sanders-Way is a 1990 graduate of Cal Poly, San Luis Obispo, where she was the ASB Student Body Vice-President. After graduation, she worked for Sun World in the Coachella Valley. Ms Sanders-Way also worked for the California Apple Commission, the California State Fair Board, and for eight years, as the agricultural representative for Senator Jim Battin. She has served as the past president of the Coachella Valley Chapter of the California Women for Agriculture and recently was re-appointed as the chairwoman of the California Regional Water Quality Control Board for the Colorado River Basin. She and her husband, Mike Way, have been married for twelve years and have two daughters, Julia and Elizabeth.

Rodger Siems graduated for Cal Poly San Luis Obispo in 1951 with a degree in Agricultural Engineering. After graduation, Rodger served in the U.S. Air Force from 1951 to 1955 and served in the Korean War. After his discharge from the Air Force, he bought acreage in Hemet and began growing alfalfa hay, oat hay, hominy corn, and several varieties of hard shelled squash and oriental vegetables.

Rodger served as a volunteer fireman at the Hemet-Ryan Airport for many years. He also was elected to the Hemet Unified School District Board as well as the RCFB Board of Directors where he served for 35 years. In 1985, Rodger was elected to the Eastern Municipal Water District Board of Directors where he served for over 21 years. He is a past Master of the Hemet Masonic Lodge and served as the state officer in 1993. Rodger has been married to his wife, Pat, for 49 years and have two grown daughters and three grandchildren.

California State Senator-elect, John Benoit, presented Ms Sanders-Way and Mr. Siems each a resolution from the state in appreciation for their (Ms Sanders-Way and Mr. Siems) dedication and loyalty to agriculture in Riverside County.

RCFB officers and directors were elected at the Annual Meeting. Grant Chaffin was re-elected to serve another year as president of the RCFB. Darl Young, Jr., Andy Domenigoni, and Richard Schmid were elected to serve as vice-presidents. Directors elected to serve one year terms were: Lee Anderson, Jr., Linden Anderson, George Cordero, Steve Corona, John Demler, Cindy Domenigoni, Ben Drake, Jeff Elrod, Dan Hollingsworth, Ellen Lloyd-Trover, Larry Minor, Alex Sanchez, Tony Schmidt, Greg Young, and David Zeiders.

The RCFB would like to thank our sponsors for their generous donations towards the Annual Meeting. The sponsors included Agri-Empire, Domenigoni Brothers Ranch, Jackson, DeMarco, Tidus and Peckenpaugh, Prime Time International, State Compensation Insurance Fund, W.D. Young & Sons/Cocopah Nurseries, Arlan Knutson Insurance Agency, and Dan's Feed & Seed, Inc.

Inside This Issue...

Happy Thanksgiving!	
Turkey Day Survey	2
Winter Driving Safety	3
Jr. Livestock Photos	4
AFBF: Passage of Prop 2	5
Calendar of Events	8

Board of Directors

**President
Grant Chaffin**

**Vice Presidents
Andy Domenigoni
Richard Schmid
Darl Young, Jr.**

**2006 Past President
Brad Scott**

**Directors
Lee Anderson, Jr.
Linden Anderson
George Cordero
John Demler
Stephen J. Corona
Cindy Domenigoni
Ben Drake
Mark Draper
Dan Hollingsworth
Richard C. Kelley
Ellen Lloyd Trover
Larry Minor
Alex Sanchez
Greg Young
David Zeiders**

**Treasurer
Anton Schmidt**

**Executive Director
Corporate Secretary
Steven A. Pastor**

**Office Manager
Stephanie Bell**

*For advertising information,
Telephone 951/684-6732
Toll-free 888/383-5684
or Fax 951/782-0621.*

Visit www.RiversideCFB.com

Riverside County Farm Bureau assumes no responsibility for statements by advertisers or for products advertised in "Riverside County Agriculture," nor for statements or expressions of opinion other than in editorials or articles showing authorship by an officer, director or employee of Riverside County Farm Bureau.

Printed by Layton Printing, La Verne,
California.

Welcome New Members
**We would like to "Thank You" for becoming
part of the Farm Bureau Family.**

2008 Thanksgiving Dinner Price Survey Results

The American Farm Bureau Federation (AFBF) announced today their annual survey results for the cost of a traditional Thanksgiving dinner. The nationwide survey said the average cost of items used to prepare a dinner for ten people came to \$44.61; that's up \$2.35 from last year's survey.

The AFBF survey found that the price for a traditional Thanksgiving menu items including turkey, bread stuffing, cranberries, pumpkin pie and all the trimmings, increased about six percent this year but still remains very affordable for most Americans.

The cost of a 16 pound turkey was the largest contributor to the overall increase in the cost of the dinner. The cost of the turkey was \$19.09 or about \$1.19 per pound. This reflects an increase of nine cents per pound, or a total of \$1.46 per turkey compared to 2007.

Fresh cranberries were up forty-six cents for a 12-oz package. Together, the turkey and cranberries accounted for about eighty percent of the increase in the cost of the meal.

Most of the increase in cost is due to higher energy prices affecting processing, packaging, refrigeration and shipping costs for food.

Farm Bureau volunteer shoppers were asked to look for the best prices on the survey items, without taking advantage of special promotional coupons or purchase deals, such as spend \$50 and get a free turkey. Farm Bureau does not make any statistical claims about the survey data, but it is a useful gauge of price trends around the nation.



Take extra care when driving in winter

By Mike Klimenko, Farm Bureau Group Manager



With the arrival of winter in California comes a dramatic shift in driving conditions. No matter where you reside in California, there is a certain unpredictability that comes with the change in seasons.

Winter conditions can change rapidly. A road can turn into a sheet of ice in minutes. If you are traveling to an unfamiliar area, you can get advisory telephone numbers regarding road conditions from your area highway patrol office, but do not call their emergency number. Be sure to bring your cell phone and tune into a local news talk radio station for bulletins on changing conditions.

The change in seasons also means the arrival of dense fog, commonly called Tule fog, which greatly increases the chances of accidents. According to the CHP, the two most dangerous situations for those driving in heavy fog are drivers who are going too fast and at the other end of the spectrum, drivers who become disoriented and stop their vehicles in unsafe places.

Here are some other safe driving tips:

- **Driving in traffic:** Slow down when there are numerous vehicles close together on the road. Be prepared for sudden stops with little warning. You should be prepared to slow down or stop at all times when driving in heavy traffic. Be watchful for brake lights in vehicles several cars ahead of you.
- **Hills and curves:** You never know what you may find on the other side of a steep hill or around a curve. If there is an obstruction such as a stalled car, you must be going slowly enough to stop. When you come to a hill or curve, drive cautiously so you are prepared to handle any emergency.
- **Slippery roads:** It is important to drive more slowly in rain. Many roads are the most slick at the beginning of a rainstorm because oil and dust have not been washed away. You should adhere to the following guidelines to help you adjust speed: Wet road—go 5 to 10 miles per hour slower; packed snow—cut speed in half; ice—slow to a crawl.
- **Rain and snow:** Your visibility can be severely reduced in a heavy rain or snowstorm. Make sure your wiper blades and defroster are in good working condition. When you can't see any farther than 100 feet, you cannot drive faster than 30 mph. When driving in snowy areas, carry chains in case you find yourself in conditions where you cannot drive without them. Make sure the chains fit your tires, and practice putting the chains on before you need to use them.
- **Be wary:** Always keep an eye on traffic behind you so you will know if cars are tailgating or coming up behind you too fast. You may have time to get out of the way before being hit from the rear. On long, steep downgrades, watch for large vehicles that can gather speed quickly.
- **Poor visibility:** It is important to keep all windows clean inside and out. Bright sun or headlights on a dirty window make it hard to see out. You should clear ice, frost or dew from all windows before you drive. And remember, to prevent carbon monoxide poisoning or drowsiness, leave your window open slightly.
- **Drive according to weather:** Slow down in rain or fog, and switch on your lights during the day if it is hard to see. No matter what the speed limit sign may say, California law says you must never drive faster than is safe for the current conditions.

Remember to drive defensively and don't rush. Allow extra time to drive to work, to go shopping, or to arrive at social gatherings.

For 65 years Farm Bureau and State Fund have been business partners. When your policy comes up for renewal, if you are not insured with State Fund, please be sure to get a quote in our Farm Bureau Group Program.

Junior Livestock Auction Southern California Fair October 2008



Robert Shea Perdue
Real Estate
Appraisal

*Real Estate Appraisals
for
Commercial, Residential
&
Agriculture*

Robert Shea Perdue, MAI

415 E. Main Road, Suite 3
P.O. Box 100, CA 92544

(951) 694-6904



The Farm Bureau would like to give many thanks to the members who have contributed to the Auction Support Fund.

With your contributions you have helped these young people continue in learning important life skills, including time management and financial responsibility. We hope that you will continue to support these great organizations with the choices that children have today. FFA, 4-H, and Grange are worth supporting.

These photos are of young people that the Farm Bureau and members like you helped support this year.

.....
Call The Metal Building Guy

- Steel Buildings
- Metal Roofing
- Metal Siding

Since 1978
John Shoemate
 Shoemate Buildings, Inc.
 La Quinta, CA
760/ 771-6102
 CA Lic. No. 479637

Temecula Valley Pipe & Supply

Wholesale & Retail
 -- We Deliver --

*PASTURE SYSTEMS	*PLUMBING
*DRIP IRRIGATION	*ELECTRICAL
*SPRINKLERS	*PIPE & FITTINGS
Toro & Rainbird	*TIME CLOCKS
Hunter & Richdel	*INFILTRATOR SYSTEMS

RANCHO CALIFORNIA INDUSTRIAL PARK
 28074 Del Rio Road
676-5678
 7-6 WEEKDAYS, 8-1 SATURDAY

Farm Bureau Disappointed by Passage of Prop 2

WASHINGTON, D.C., November 5, 2008 – The American Farm Bureau Federation today expressed disappointment in the passage of California’s Proposition 2, a ballot initiative that phases out the use of modern housing methods in the production of eggs, pork and veal. Passage of the measure will cause more of these products to be produced outside the state of California and is likely to have serious impacts for consumers and California’s egg producers.

“The result points out the lack of understanding that people who voted for Proposition 2 have of agriculture, and it highlights the need for all of America’s farm and ranch families to focus on engaging consumers to communicate their knowledge of and commitment to animal care,” said AFBF President Bob Stallman. “The realities of modern, family-owned and -operated agriculture and the professional dedication of our farm families are largely not understood by America’s consumers. As an industry, we must help non-farmers understand our industry.”

The success of this measure and other such anti-animal agriculture initiatives will likely trigger increased food imports from countries that do not have food safety laws equivalent to those in the United States, AFBF believes.

“If eggs and other food products produced by California farmers are displaced by production from other nations, we believe that Proposition 2 will have serious implications for food safety,” Stallman said.

Stallman said passage of Proposition 2 points out the continued need for farm and ranch families to “talk to neighbors, lawmakers, business leaders – essentially anyone who will listen – to help them acquire a realistic picture of modern agriculture.”

“While caring for their animals is the clear number one priority for America’s livestock producers, it is also clear that correcting misinformation from those opposed to modern farming is a close second,” Stallman said.

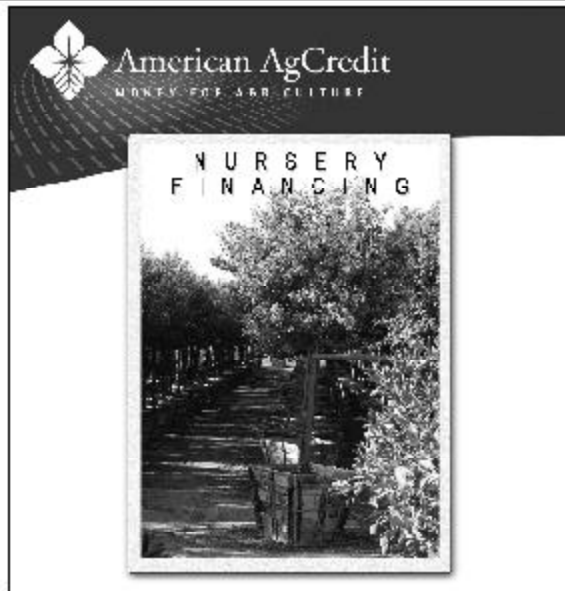

As a nursery owner, you've got enough on your mind without worrying about financing. American AgCredit can make things easier. For nearly a century, we've been committed to your success, offering competitive rates and financing solutions for your individual needs, including loans for real estate, operating expenses and greenhouse construction. Call us today at 1.800.900.4865 or visit www.agloan.com.

Riverside (951) 781-8100 Indio (760) 342-4728
 Ontario (909) 947-2371 Escondido (760) 746-5055

Part of the Nationwide Farm Credit System

EQUAL OPPORTUNITY LENDER

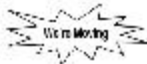

**THE INDIO OFFICE
OF THE
AGRICULTURAL COMMISSIONER
COUNTY OF RIVERSIDE**

MOVES TO A NEW LOCATION

Tentative Monday, November 24th, 2008*
(*Subject to change)

81077 India Boulevard, Suite K
Indio, CA 92201

Staff will work diligently to ensure the least amount of disruption and will strive to provide the best possible services during this relocation.

Please note that the Department's telephone & fax numbers will also change:
Phone Number: (760) 342-5070
Fax Number: (760) 342-0734

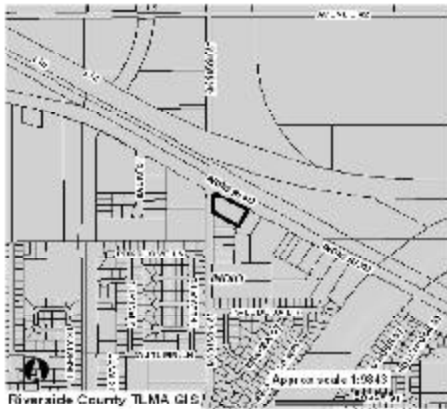

**SCAQMD
AGRICULTURAL ASSISTANCE PROGRAM**

**FUNDING FOR
STATIONARY AGRICULTURAL ENGINES
TO COMPLY WITH AQMD RULE 1110.2**

• SAVE THE DATE •

Workshops at the following dates and locations:

November 25, 2008 Western Riverside Council of Governments 2nd Floor, Room 2B 4080 Lemon Street Riverside, CA 92501 10:30 a.m. – 12:30 p.m.	December 2, 2008 CVWD Rammonds Room 35995 Avenue 52 Coachella, CA 92236 10:00 a.m. – 12:00 noon	December 11, 2008 San Bernardino County Farm Bureau 210 S. Riverside Ave. Redha, CA 92376 10:00 a.m. – 12:00 noon	January 6, 2009 SCAQMD Room EC3-CCS 21865 Copley Drive Diamond Bar, CA 91765 10:00 a.m. – 12:00 noon
---	--	--	---

Project Funding Criteria

- Agricultural engine >90 hp required to comply with SCAQMD Rule 1110.2 by January 1, 2010
- Stationary non-emergency engines previously installed in the location prohibited by the rule must be located in prohibited locations as of 1/1/2010
- Replacement of existing engine with a stationary engine with Rule 1110.2-compliant emission controls
- Funding up to 85% of replacement cost
- Projects must be operational prior to January 1, 2010
- Quality of projects will be funded on a first come first served basis until May 25, 2009

For additional information contact Allison Bales at (951) 256-2216, abales@sqmd.gov



**South Coast
Air Quality Management District**
www.scaqmd.gov

Clearing the air that we breathe.



FRITTS 
FLEET CENTER
7990 Auto Drive • Riverside



FLEET PRICING
on Your Business
or Personal Vehicles
NEW OR USED

951-353-8800

LARGEST VOLUME COMMERCIAL FLEET DEALER WEST OF THE ROCKIES!

**Over 200 YEARS
Combined Experience**



H.L. FLETCHER - 35 **STEVE - 6** **LEROY - 15** **MAC - 20**
Fleet Director 951-288-9906 951-518-3210 909-214-9011



CHUCK - 25 **DAVE - 35** **HANK - 32** **ERIC - 19**
909-223-2656 909-732-9366 951-333-6142 951-235-6309

OUTSIDE SALES TEAM

We Come to You to Meet All Your Vehicle Needs



BILL - 21 **DAVE - 11** **STACY - 10**
Marketing Director 909-838-3263 951-692-0600
Riverside Riverside • Temecula
951-848-3700 951-692-0300

www.frittsfleet.com



HEALTH CARE COVERAGE MADE SIMPLE

Health insurance that fits your budget and your life is one of the many benefits of California Farm Bureau membership.

- PPO insurance plans with a choice of co-pays and deductible choices, including the new \$0 deductible plan
- Medicare Supplement plans
- Dental plans and Supplemental Term Life Insurance
- CashNet Plan — supplemental medical expense plan

Call your authorized Health Net agent or call us for information about an agent near you, and you'll be one step closer to a health plan that works for you!

(800) 909-3447 (option 1, then option 3)



CAG1352

California Farm Bureau health insurance plans are underwritten by Health Net Life Insurance Company; coverage is subject to individual underwriting. Health Net Dental Scheduled Reimbursement Plan and Dental HMO Plan is underwritten by Safeguard Health Plans, Inc. Health Net Life Insurance Company is a subsidiary of Health Net, Inc. Health Net® is a registered service mark of Health Net, Inc. Farm Bureau is a registered service mark of American Farm Bureau Federation used under license by Health Net. All rights reserved.

Riverside County AGRICULTURE

The official publication of
Riverside County Farm Bureau, Inc.
www.RiversideCFB.com

A private, nonprofit organization serving farmers throughout Riverside County since 1917

Our 62nd Year of Publication: Volume LXII, Number 11, November 2008.

(USPS 466-900) Published monthly by Riverside County Farm Bureau, Inc., a non-profit organization serving farmers and ranchers at 21160 Box Springs Road, #102, Moreno Valley, California 92557, Telephone 951/684-6732 or Fax 951/782-0621. Subscriptions: \$1 per year of membership dues. Periodicals postage paid at Riverside, California 92507, under act of March 3, 1887. POSTMASTER: Send address changes to RIVERSIDE COUNTY FARM BUREAU, 21160 Box Springs Rd., #102, Moreno Valley, CA 92557.



STATE FUND & FARM BUREAU—
A LONG STANDING PARTNERSHIP SINCE 1945.

WHAT'S ONE WITHOUT THE OTHER?

To be successful in agriculture today you've got to have both feet firmly planted on the ground. We know that because for more than 50 years we've stood side by side with California's farmers. Our rock-solid partnership with the Farm Bureau has helped make us one of the most stable and secure workers' compensation insurers in the state.

To see why so many farmers find State Fund a good fit, talk to your broker, or give us a call at 1-800-773-7667.



STATE FUND
INSURANCE
FUND
www.sff.com



2008 CALENDAR OF EVENTS

- ☼ December 2nd – 10 am General Plan Advisory Committee – 10 am, 4th Floor, CAC, Riverside.
- ☼ December 2nd – WRCAC, 9 am, Nuevo Water District office.
- ☼ December 7th – 10th, CFBF Annual Meeting. Call for details.
- ☼ December 11th – Heritage Corridor meeting – RCFB office, 1:30 pm.
- ☼ December 24th – 26th – RCFB office will be closed to observe the Christmas holiday.



Chris Thompson
President
(760) 360-6937
78-501 Avenue 40
Indio, CA 92202
FAX (760) 772-1848
cigt@yandoo.com
www.greendesertnursery.com

Cactus
Specimens
Desert Trees & Shrubs

CRABTREE & ASSOCIATES, CPAs

10020 INDIANA AVENUE, SUITE 211
RIVERSIDE, CALIFORNIA 92503
TELEPHONE (951)352-0255 - FAX (951) 352-8686

Serving the Inland Empire Farming Community

- Financial Statements
- Tax Return Preparation
- Tax Planning & Estate Tax Strategies
- Export Tax Deferrals



Desert Cities Pipe & Supply

- Wholesale & Retail
-- Delivery Available --
- | | |
|-------------------------------------|-----------------------|
| * AGRICULTURAL IRRIGATION EQUIPMENT | * PLUMBING |
| * PASTURE SYSTEMS | * ELECTRICAL |
| * DRIP IRRIGATION | * PIPE & FITTINGS |
| * SPRINKLERS | * TIME CLOCKS |
| Toro-Rainbird-Hunter-Irritrol | * INFILTRATOR SYSTEMS |

Serving the industry since 1975.

OPEN TO THE PUBLIC

52-101 Industry Way, Coachella
(760) 391-5594
7-4 WEEKDAYS, 8-1 SATURDAY